



**Striix™**

*Linear Acoustic Panels*

*Ceiling & Wall Panel Series*





## Striix™ Linear Acoustic Panels

*Performance with Precision.*

Striix™ brings rhythm, dimension, and high-performance sound absorption together in a linear system designed for both wall and ceiling applications. Its precision-cut acoustic baffles create a sculptural effect that blends architectural clarity with acoustic comfort. Available in a range of panel types and layout options, Striix™ transforms open ceilings and vertical surfaces into calm, visually engaging environments.



Key Features

- Multi-depth acoustic blade profiles
- Available for both ceiling and wall applications
- 9mm PET felt: 75% recycled content, 100% recyclable
- Precision CNC-cut baffles with 1" or customizable spacing
- Mounts to standard 9/16" or 15/16" ceiling tee grids
- Mounts with wall z-clips or conceal mount screws
- Capped baffle edges available for exposed installations
- NRC up to 1.00 depending on configuration
- Custom patterns, sizing, and colors available

Dimensions and Specifications

ATTRIBUTE	DETAIL
Ceiling	24" x 48" (standard)
Wall	24" x 108" (standard)
Hard Surface Ceiling Mounting	Z-Clips, Conceal Mount Screws and FRP Adhesive
Wall Mounting	Z-Clips, Conceal Mount Screws and FRP Adhesive





Standard Panel Types

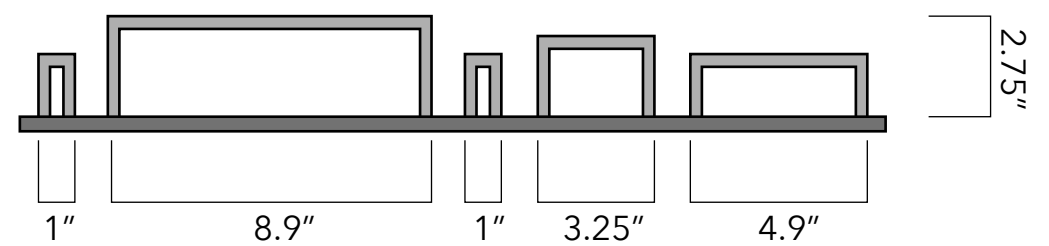

Striix - 1

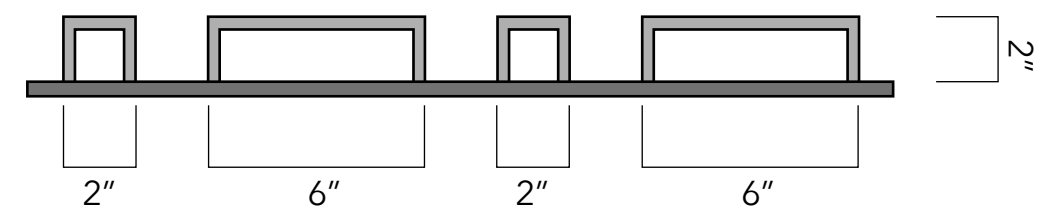

Striix - 3

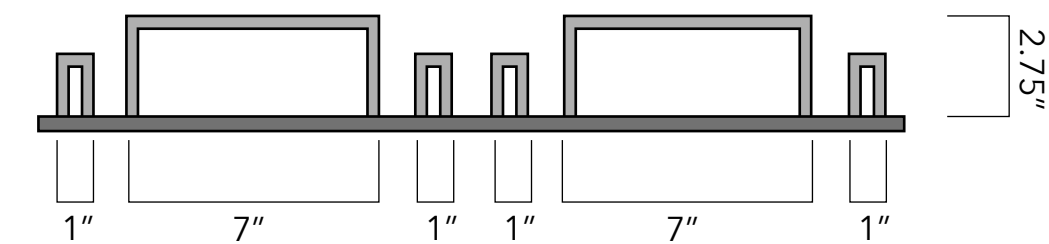

Striix - 2

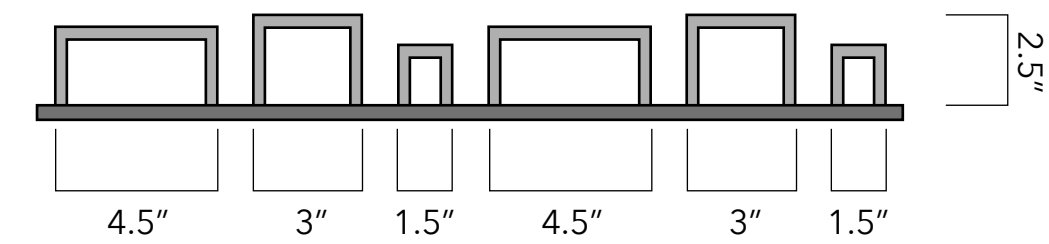

Striix - 4

Back of Striix panel

- .5" Space between the panel and the wall
- Interlocking notches insert through the back panel for precise baffle alignment.

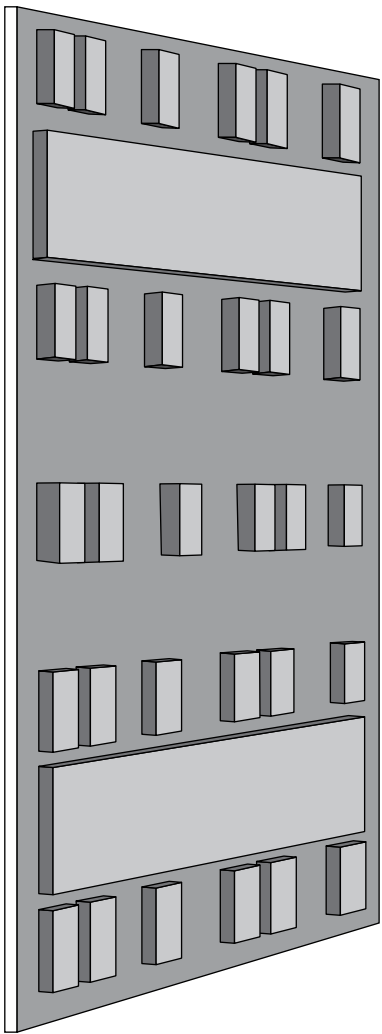

Striix Panel

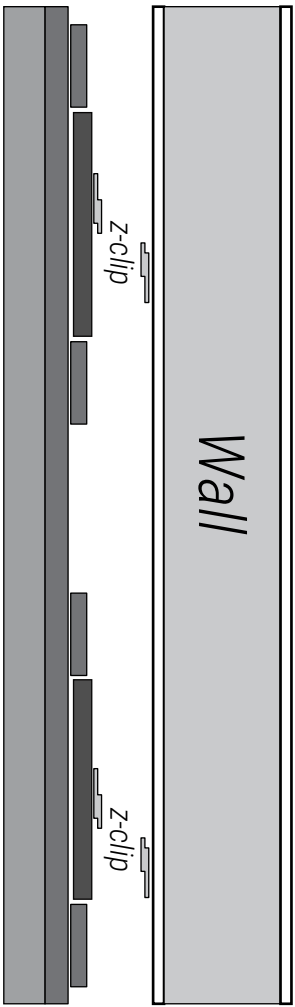

## Installation & Mounting

### Ceiling Installation Options

- Concealed Screws
- FRP Adhesive

Use concealed screws and adhesive for a stronger bond

FRP Adhesive



Concealed Screws

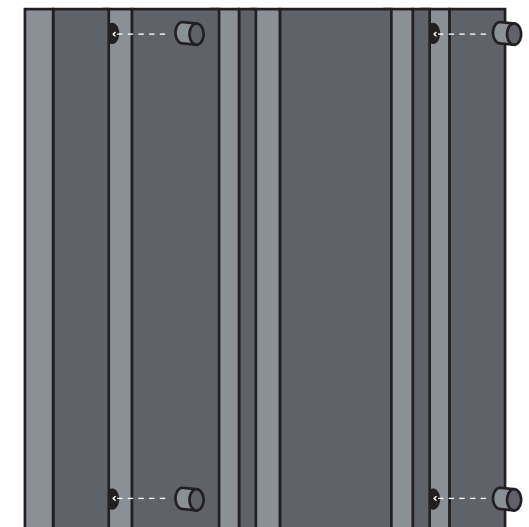

### Wall Mounting:

- Concealed Screws
- FRP Adhesive
- Z Clips

Use concealed screws and adhesive for a stronger bond

Z Clip

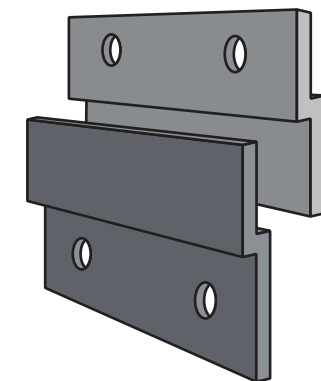

## Design Your Space

### Layout & Quantity

- Define the desired area for ceiling and/or wall coverage
- Mix panel types for visual rhythm or use uniform panel design for cohesion

### Orientation & Spacing

- Align blades vertically, horizontally, or mix for dynamic designs
- Allow minimum 1" spacing between baffles

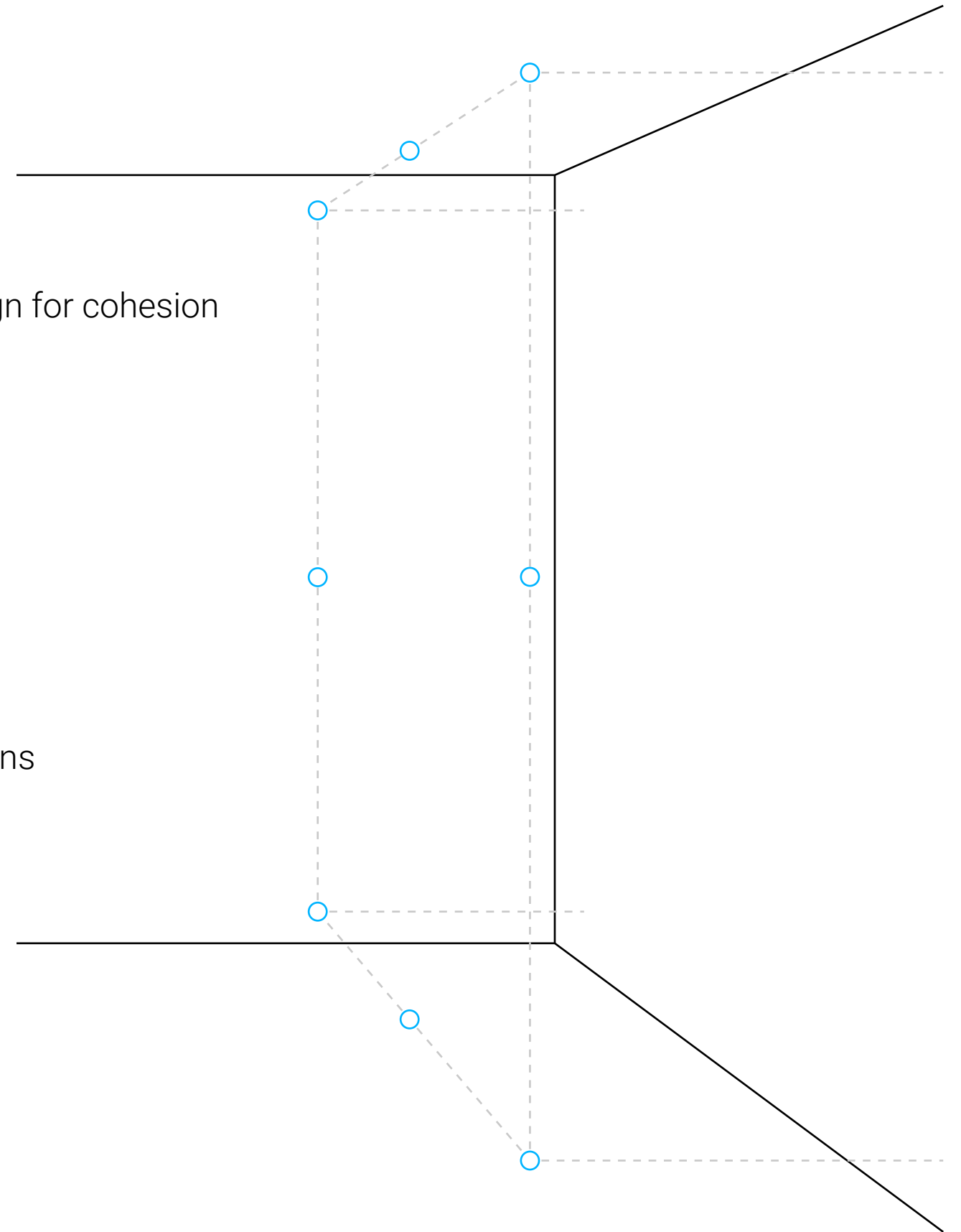

## Design Your Space

### Edge Conditions

- Capped baffles recommended for exposed edges
- Panels are field-trimmable for exact fit
- Use X joiners to help connect the panels more seamlessly

### Color Selection

- Choose contrasting or tonal combinations between baffles and backer
- Full color palette + custom digital print finishes available

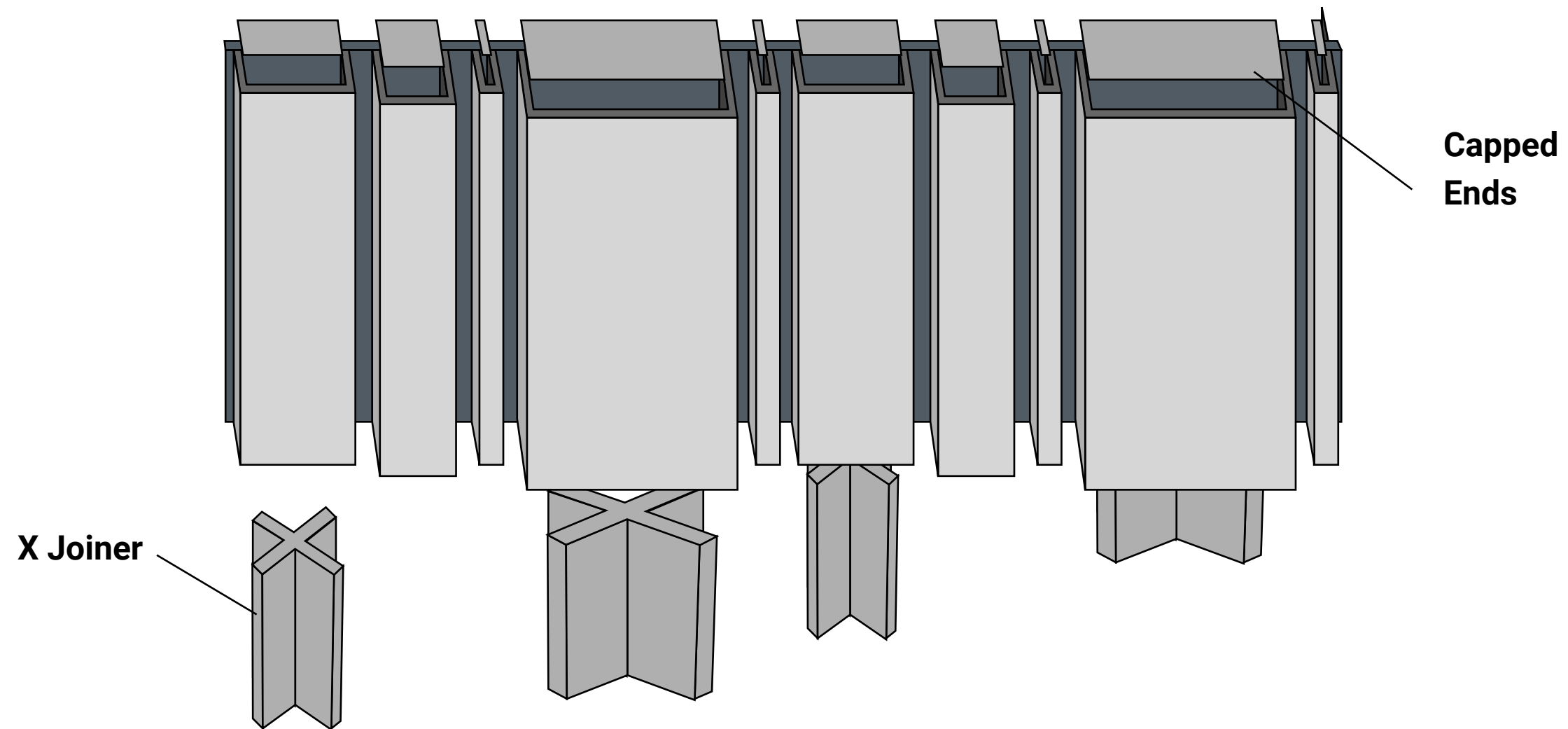

## Customization

- **Panel Sizes:** Custom lengths and patterns available
- **Baffle Color Options:** Wood Grains or Solid Felt Colors
- **Backer Color Options:** Wood Grains or Solid Felt Colors
- **Layout Coordination:** Panels can be modified in field to accommodate fixtures

Panel Sizes

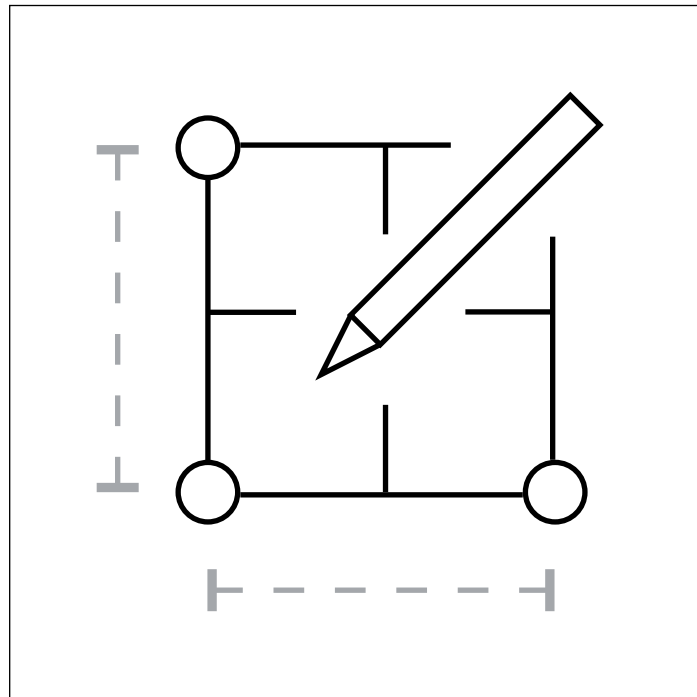

Baffle Color

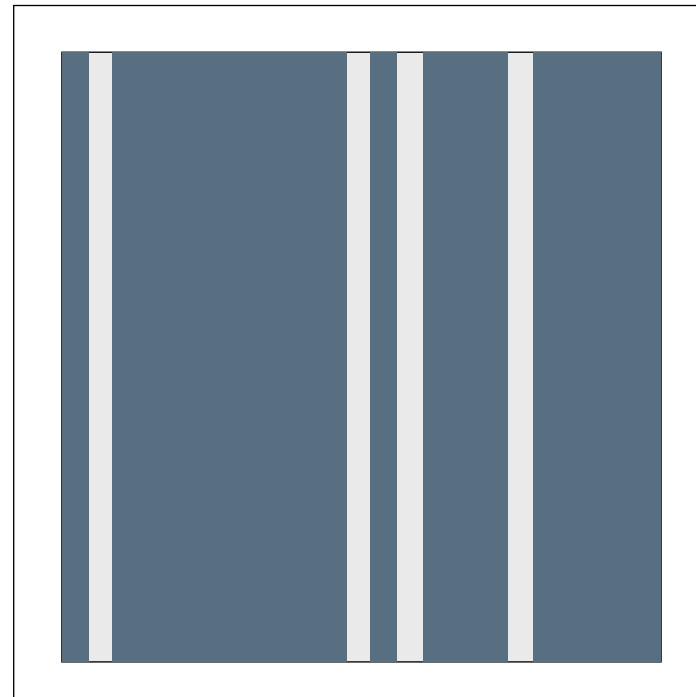

Backer Color

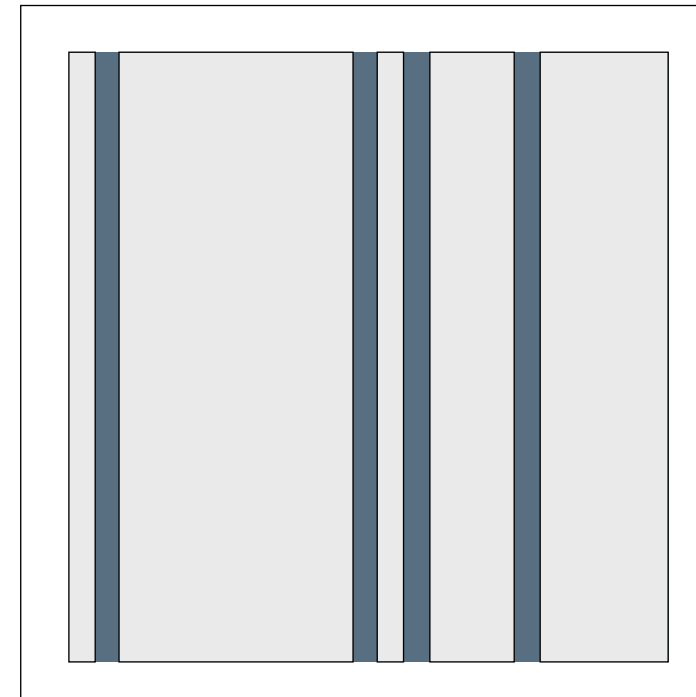

Layout Coordination

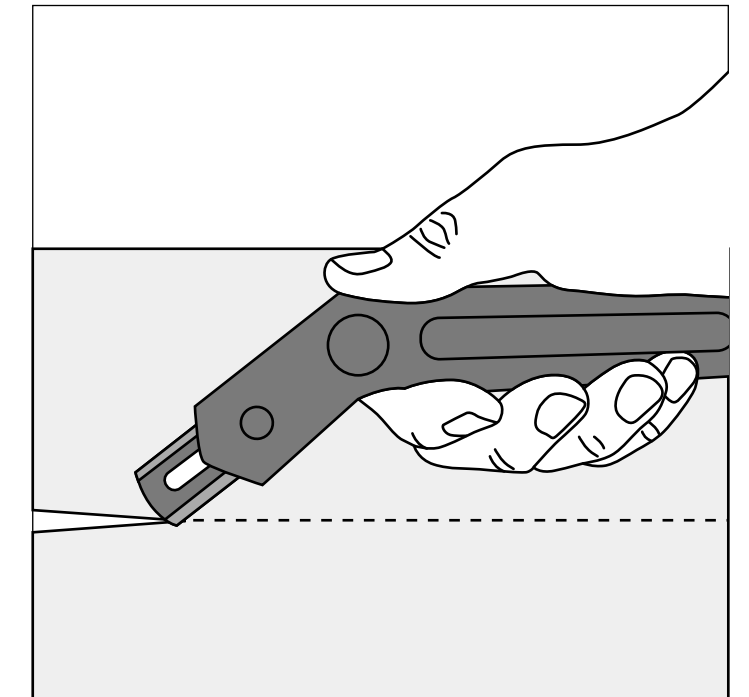



## *Standard Finish Options – Bring Wood to Life.*

Choose from 8 warm, neutral, or dark wood grains.



Whitewashed Maple



Urban Ash



Brown Walnut



Natural Oak



Driftwood



Blonde Birch



Deep Walnut



Classic Walnut





*Finish Options - Color with Character. Form with Purpose.*

Choose from ONNiT’s 32 standard PET colors, ranging from subtle neutrals to bold accent hues. Create tonal variations or contrast within a single wall layout to highlight form and texture.



**Custom Options:** • Custom color matching available • Multicolor tile sets available upon request





## *Sustainability + Compliance*

- Made from 75%+ post-consumer recycled PET
- Made with Certified OEKO-TEX® and Global Recycled Standard (GRS) materials
- Formaldehyde-free and low VOC
- Moisture, mold and mildew resistant
- Contributes to LEED MR and EQ credits





Acoustic Testing Data

Volume of the reverberation room	Vs, m3	240	Installation Type:	E200
Room temperature	t1, °C	13	t2, °C	13
Relative humidity of test rooms	H1, %	70	H2, %	70

Sample description:

Sample Size (width*length), mm	1220*2440	Thickness, mm	9.0
Edge treatment	/	Mass, kg/m²	2.05
Test Area, m²	10.8		



Frequency (Hz)	αs
100	0.25
125	0.37
160	0.39
200	0.64
250	0.76
315	0.82
400	0.84
500	0.96
630	0.89
800	0.79
1000	0.67
1250	0.76
1600	0.80
2000	0.80
2500	0.83
3150	0.88
4000	0.87
5000	0.83
NRC	0.80
SAA	0.80

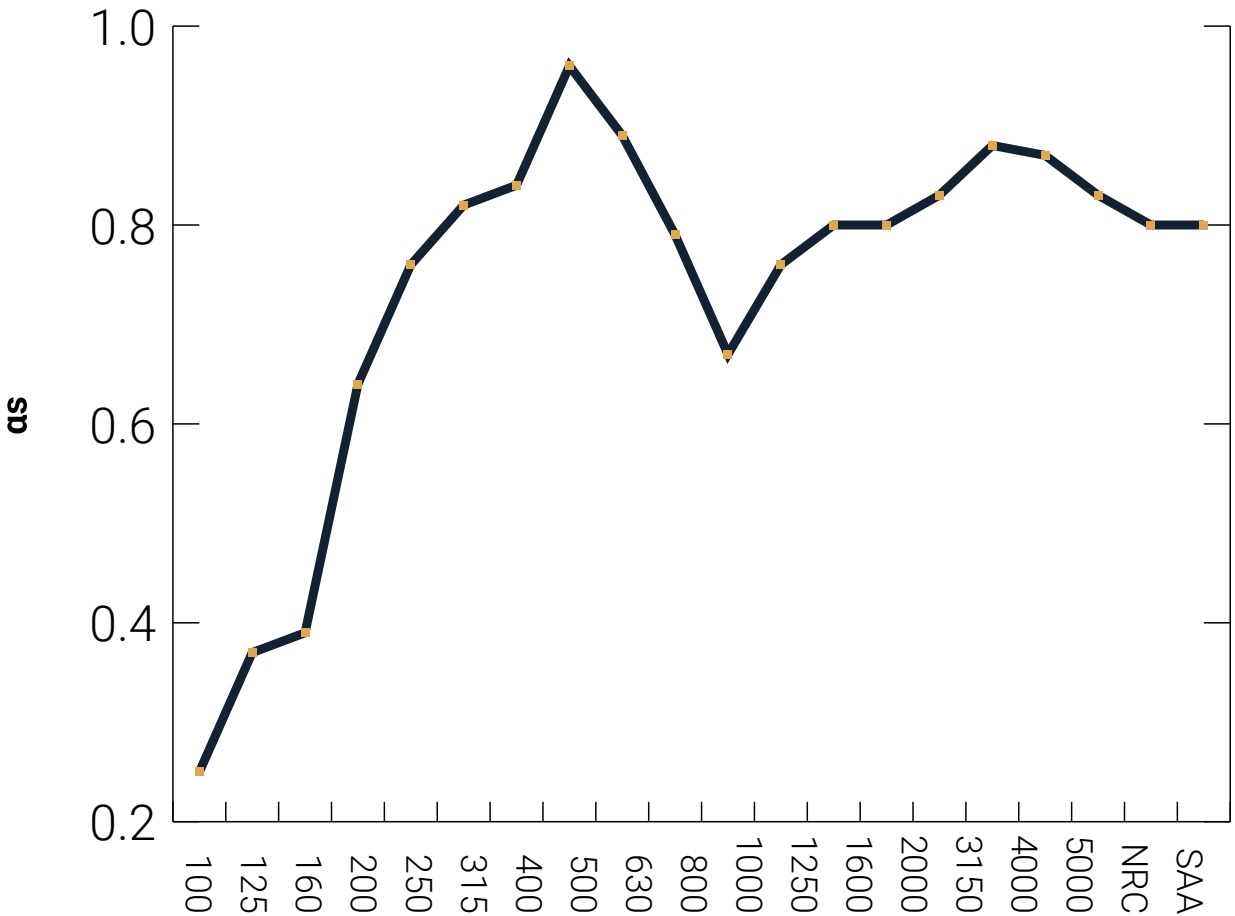



info@onnitsystems.com

(801) 619-7044



*Visit our online form and  
configuration system*